

PRIVATE ROAD

CORMORANT ROAD

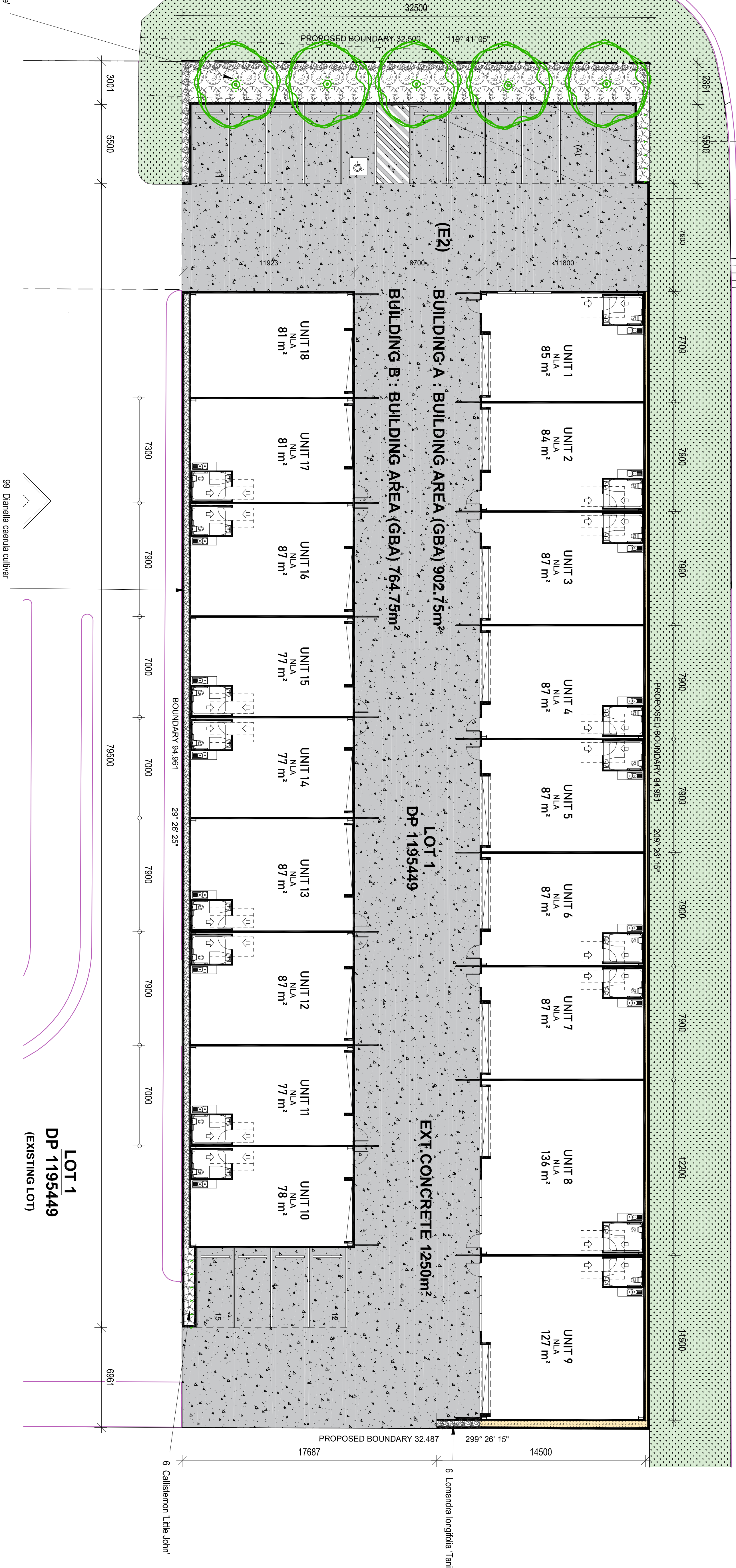

- 33 Acmena smithii 'Cherry Surprise'
- 26 Callistemon 'Great Balls of Fire'
- 6 Callistemon 'Little John'
- 5 Cupaniopsis anacardioides
- 63 Lomandra longifolia 'Tanika'

LEGEND

- CONCRETE PATHS & DRIVEWAY
- TURF - REFER TO SHEET 3 FOR DETAILS
- 100mm COMPACTED RHYOLITE TO SHADED AREAS - REFER TO SHEET 3 FOR DETAILS
- 2.1M HIGH STEEL POST & CHAINMESH BOUNDARY FENCE

PLANT LEGEND

- ACS ACMENA CHERRY SURPRISE
- CGBF CALLISTEMON GREAT BALLS OF FIRE
- CLJ CALLISTEMON LITTLE JOHN
- CA CUPANIOPSIS ANACARDIOIDES
- DCTV DIANELLA CAERULEA CTV
- LT LOMANDRA TANIKA

Bar Scale 1: 150 (A1), 1: 300 (A3)
0 1 2 3 4 5 6 7 8 9 10



PLANT SCHEDULE

TREES, SHRUBS, GRASSES & GROUNDCOVERS			
ID	Botanical Name	Common Name	Pot Size Qty mm/ltr Mature Size W x H mtrs
ACS	Acmena smithii 'Cherry Surprise'	Red tipped lilly pillly	33 200mm 2 x 2.5m
CGBF	Callistemon 'Great Balls of Fire'	Red bottlebrush	26 150mm 1.5x1.5m
CLJ	Callistemon 'Little John'	Dwarf red bottlebrush	12 200mm 1.5x1.5m
CA	Cupaniopsis anacardioides	Tuckeroo	5 25ltr 8 x 8m
DCTV	Dianella caerulea cultivar	Cultivar flax lillies	99 150mm 7 x 7m
LT	Lomandra longifolia 'Tanika'	Dwarf mat rush	69 150mm 7x.7m
ALL HEIGHTS ARE AVERAGE DEPENDENT ON SOIL, CLIMATE, MAINTENANCE, ETC.			

DATE

BY

AMENDMENT

LANDSCAPE DESIGNER

10 KANWARY CLOSE,
RAYMOND TERRACE, NSW. 2324
John A. Kime
Mob. 0412582966
email: gardentiora704@gmail.com
Member ALDM
Diploma in Horticulture (Landscape Design), Cert. Ag

IN ASSOCIATION WITH:

Mishka Stenbeck
P.O. BOX 203 RUTHERFORD NSW 2320
Mob: 0422406688
email: mishkas@optusnet.com.au
Member ALDM
Diploma in Landscape Design

SITE ADDRESS

INDUSTRIAL UNITS
LOT 1, DP 1195449
130 CORMORANT ROAD
KOOBRAGANG

CLIENT

BROWN COMMERCIAL
BUILDING

ARCHITECT - DRAFTSMAN

BROWN COMMERCIAL BUILDING

2 Level Glass
Rooftop
P.O. Box 536
Forbes NSW 2323
Ph: (02) 7546 0718
www.brownbuild.com.au

DRAWN

JK

08/01/2024

SHEET

2 OF 3

1:150 @ A1
1:300 @ A3

MS

JOB No.

BROW111223

DRAWING TO BE READ IN CONJUNCTION WITH THE ARCHITECTS--STORMWATER--ENGINEERS PLANS PLUS ASSOCIATED SHEETS ATTACHED

INITIAL PREPARATION

Verify all dimenstions on site prior to commencement, locate all underground services and ensure no damage occurs to them throughout the contract. Comply with the requirements of the Council site guidelines in reference to erosion and sediment control regulations and other environmental controls to contain all within confines of the site. Spray with approved herbicide weed killer to all proposed lawn and garden areas to manufactures directions. Spray all weeds before commencement of any site works are carried and throughout the contract so as to suppress any weeds that may arise. Source all plants before start of job so the time factor to purchase from species list, will be true to plant schedule. The trees and shrubs recommended may sometimes be difficult to source due to times of year, weather, disease etc, this being the case, please inform early so arrangements to substitute can be made. Excess soils and contaminated soil are to removed within the guidelines of the council requirements to approved sites.

SOIL PREPARATION
Cultivate to the minimum depth of 200mm in all garden areas and 100mm depth in all lawn areas; add a clay breaker to all garden areas, before the addition of garden soil is added. In all areas where fill is required, gain required levels using a premium soil mix. Where excavation is required as with clay excavate as required to allow for addition of 200-400mm depth of premium garden soil to garden areas and 100-300mm depth of topsoil to lawn areas. Undertake all required action to ensure that no root balls of proposed plants sit in clay wells and that all garden and lawn areas drain satisfactorily. It is the contractor's responsibility to ensure the end result of the project is that all lawn and garden areas drain sufficiently (both surface and subsurface), are at required finished levels and have sufficient soil depths to enable lawn and plants to thrive and grow. Soil levels are to allow for the addition of turf and mulches to specified requirements.

GARDEN EDGING
EDGING: Timber edging shall be located to all planter bed edges where meeting new or existing turfed areas. Use 38x150mm treated pine edging with 50x50 pegs at 1200 centres finished 30mm below top of edging.

PLANTING
Purchase plants from an approved nursery that supplies plants that are true to type and species, healthy and able to store at nursery to maintain vigor before planting. Plant within 24hrs of plants being delivered. Set out plants as indicated on plan. Plant holes shall be dug approximately twice the width and 100mm deeper than the plant root balls that they are to receive. Add fertilizer, followed by 100mm of garden soil shall be placed into the base of hole and lightly consolidated. Remove plant from container install and backfill with garden soil and firmed into place. Base of stem shall finish flush with finished soil level. Thoroughly water all plants on first planting to soak soil of plant and surrounding soil so as to allow roots to adjust, do not allow drying out. Water regular over the first 3-4 weeks.

FERTILISING
Use slow release fertilizers such as osmocote and or agriform tablets on all plants.

MULCHING
Install 100mm minimum of Forest mulch as a mulch over all gardens. Shaded areas mulch with 10-25mm pebble mulch with weedmat under.

GRAVEL AREAS
- Consolidated crushed rhyolite, 100mm thick, over a compacted road base. Contain areas between gardens & gravel with timber edging.

RETAINING WALLS
Erection of masonry block retaining walls treated timber retaining walls to be as per retaining wall specification guidelines. All retaining walls and footings to remain within the confines of boundary.

TURF
Prepare for, level and lay cultivated Buffalo turf to all areas nominated on the plan as being lawn. To be layed within 24 hrs of delivery on site, making sure all areas are level for drainage, garden edging and paths.

COMPLETION
Prior to practical completion removal from site all unwanted debris occurring from work. Satisfy council that all landscaping work has been undertaken in strict accordance with council's landscape codes and guide lines.

At the completion of landscape works and prior to the issue of the Certificate of Practical Completion.
Carry out the following during the maintenance period(determined by Builder). These works shall include but not limited to watering, weeding, fertilizing, pest and disease control, reurfing, staking and tying, replanting, cultivation, pruning, aerating, renovation, top dressing and the like.

EXISTING TREES
The existing trees to be retained on site are to be protected by surrounding with a 1.8m high chainmesh fence 3.00m from the base of the tree. This fence is to be erected prior to works commencing on site and is to be retained until all building works are completed. The enclosed area is to remain free of materials, machinery, vehicles or site sheds. With this preparation is to protect the existing tree and its critical roots from mechanical damage, compaction or any other adverse impacts resulting from construction activity and allowing the trees to grow the optimum growth once all works have been finalised.

TREES STAKE DIAGRAM

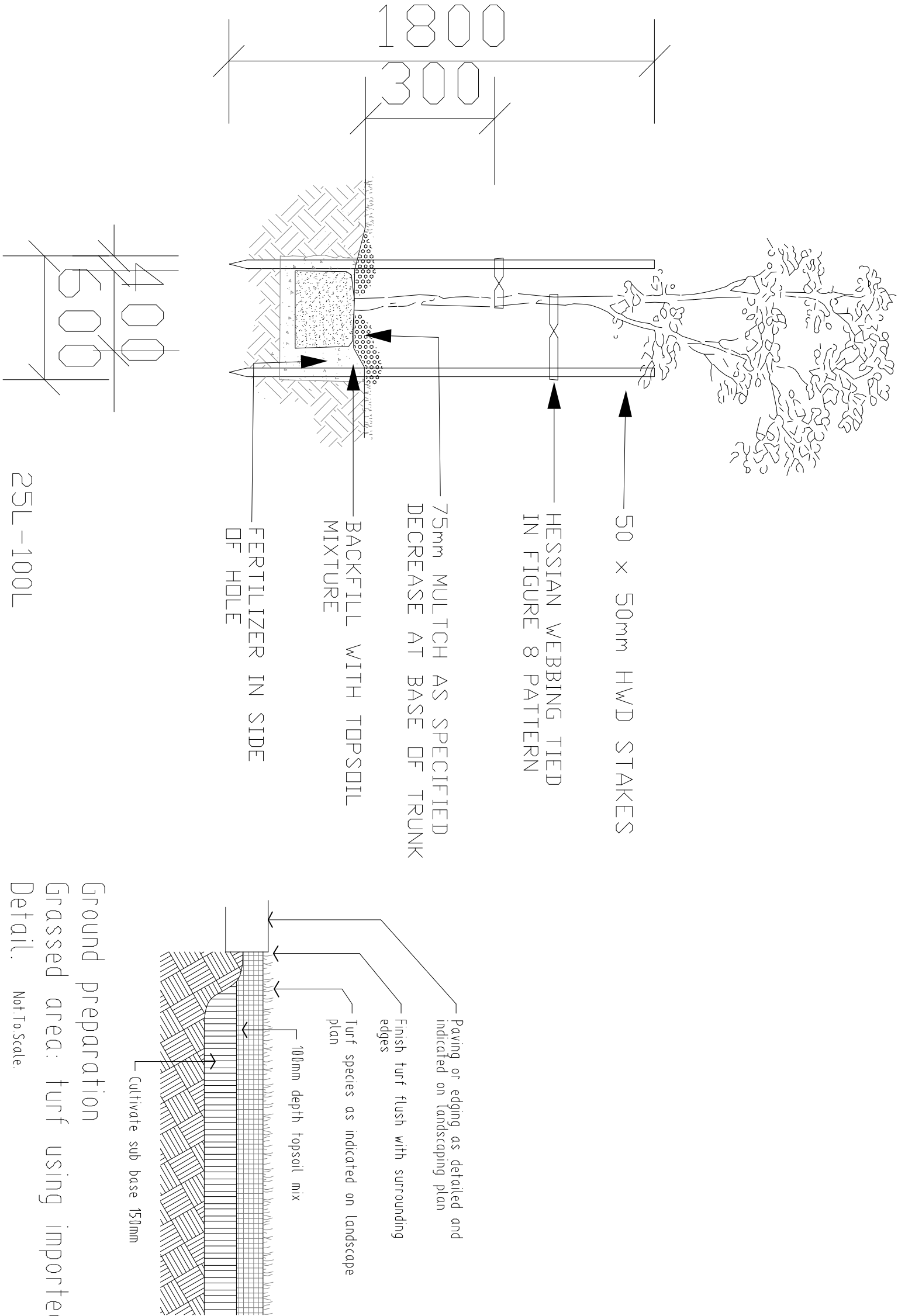

Planting in garden beds
Detail. Not To Scale

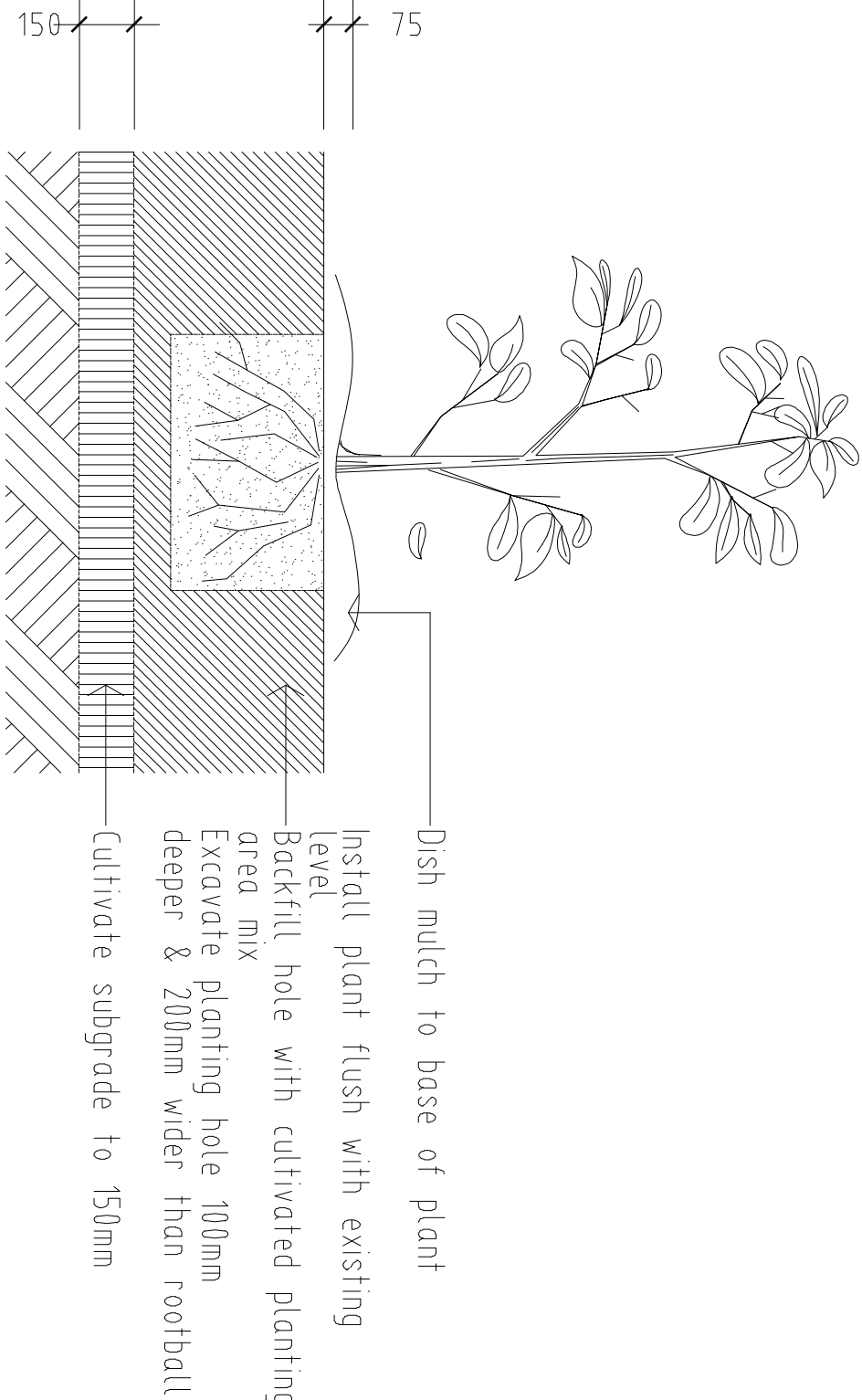

Ground preparation
Grassed area: turf using imported topsoil
Detail. Not To Scale

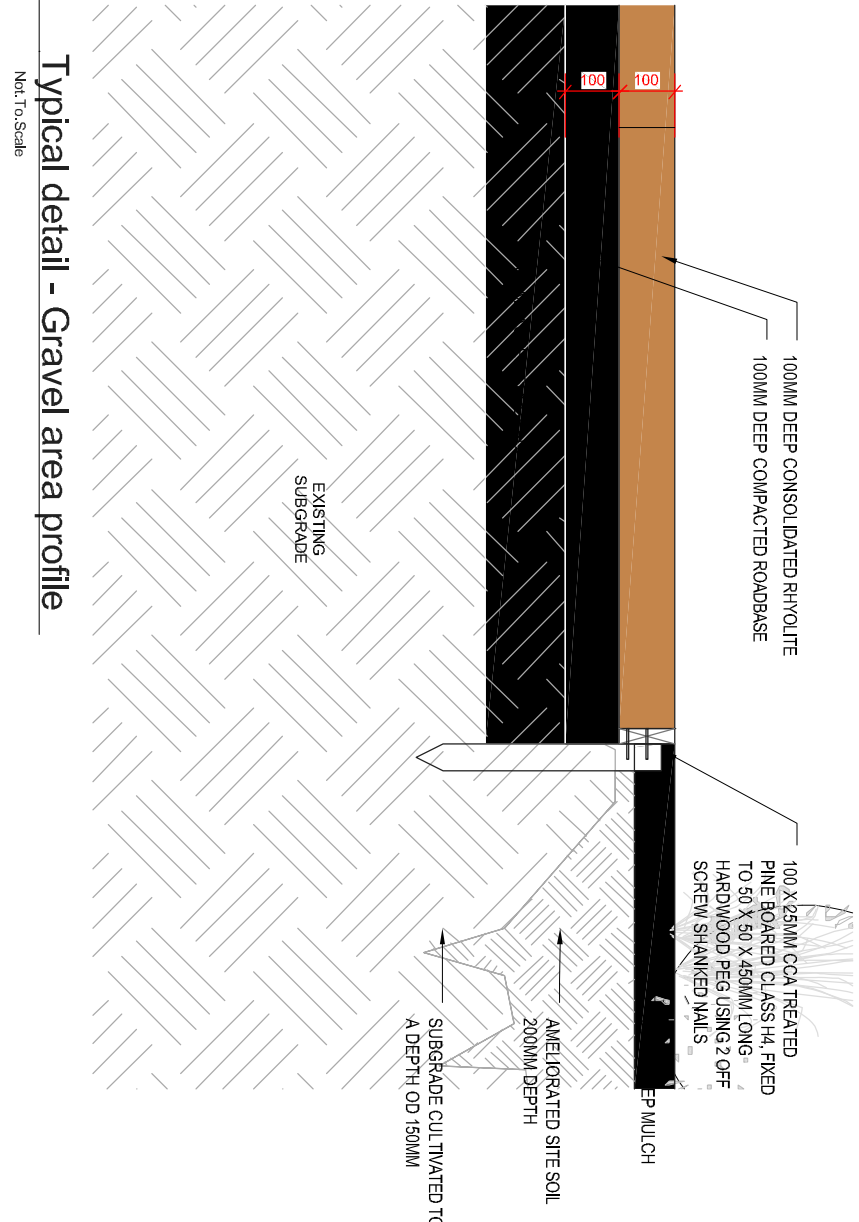
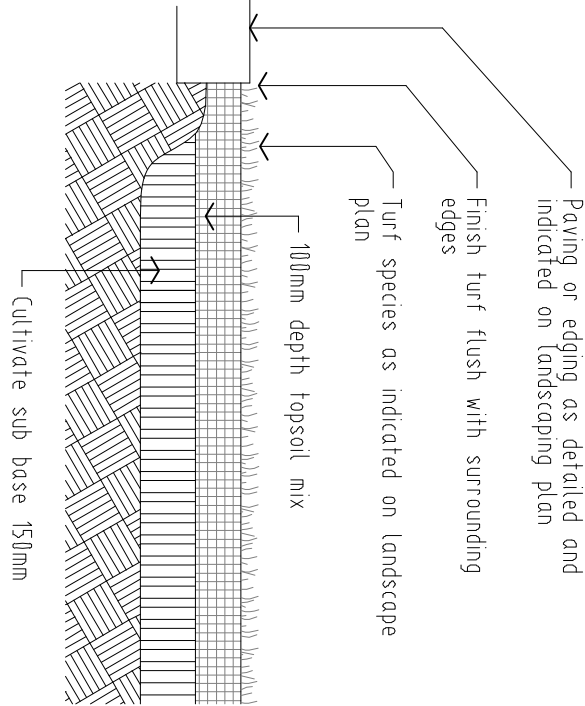

Typical detail - Gravel area profile
Not To Scale

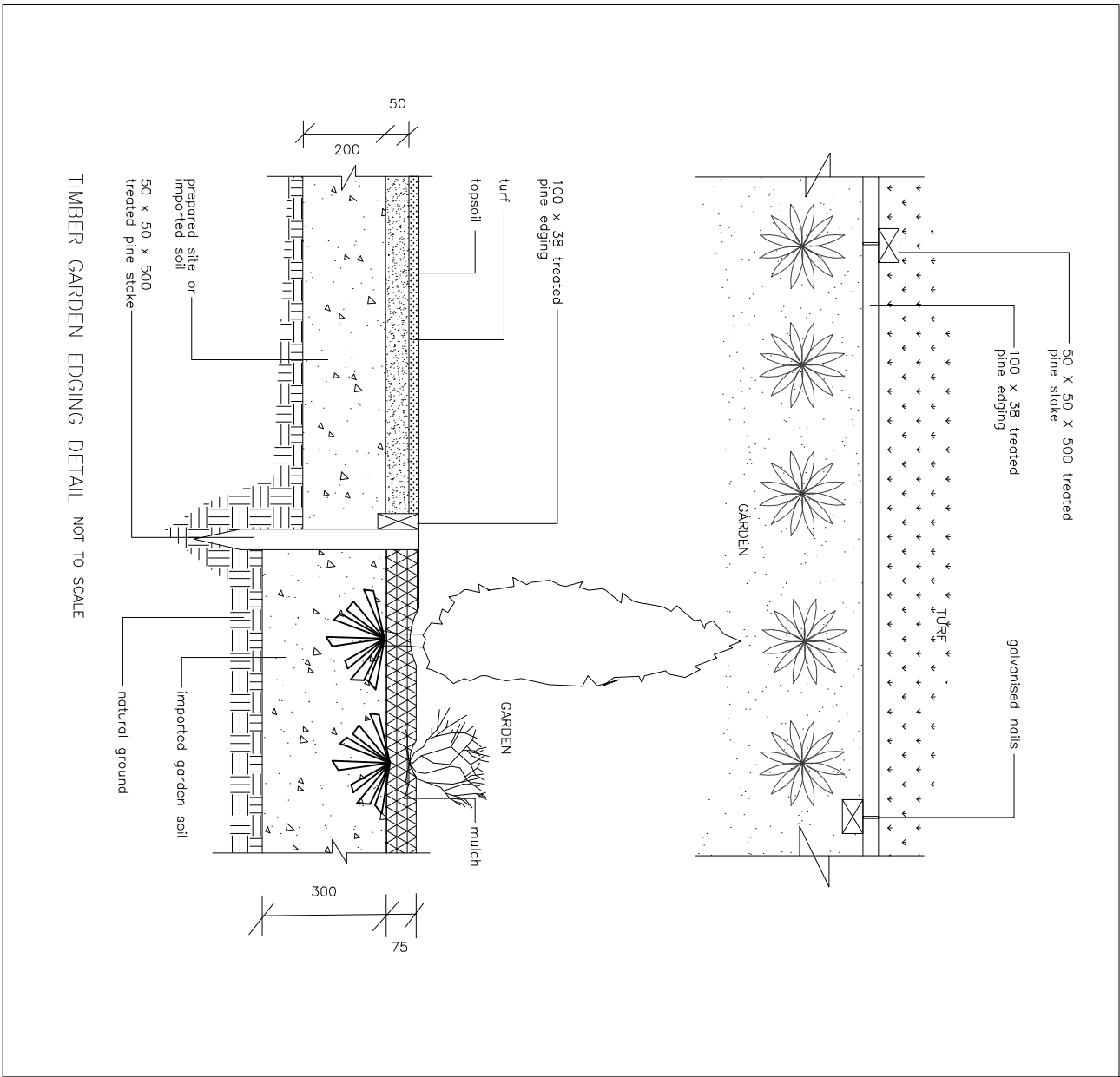

PLANT SCHEDULE			
TREES, SHRUBS, GRASSES & GROUNDCOVERS			
ID	Botanical Name	Common Name	
ACS	Acmena smithii 'Cherry Surprise'	Red tipped lilly pillly	
CGBF	Callistemon 'Great Balls of Fire'	Red bottlebrush	
CU	Callistemon 'Little John'	Dwarf red bottlebrush	
CA	Cupaniopsis anacardioides	Tuckeroo	
DCTV	Dianella caerulea cultivar	Cultivar flax lillies	
LT	Lomandra longifolia 'Tanika'	Dwarf mat rush	

Pot Size	Mature Size	
Qty	mm/ltr	W x H mtrs
33	200mm	2 x 2.5m
26	150mm	1.5x1.5m
12	200mm	1.5x1.5m
5	25ltr	8 x 8m
99	150mm	.7 x .7m
69	150mm	.7x.7m

ALL HEIGHTS ARE AVERAGE DEPENDENT ON SOIL, CLIMATE, MAINTENANCE, ETC.

DRAWING TO BE READ IN CONJUNCTION WITH THE ARCHITECTS--STORMWATER--ENGINEERS PLANS PLUS ASSOCIATED SHEETS ATTACHED

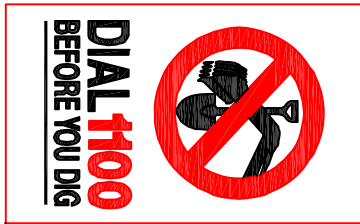

DATE	BY	AMENDMENT

LANDSCAPE DESIGNER
JK's GARDEN CREATIONS
10 KANWARY CLOSE,
RAYMOND TERRACE. NSW. 2324
John A. Kime
Mob. 0412582966
email.gardentora704@gmail.com
Member ALIDM
Diploma in Horticulture, Escape Des, Cert Ag
IN ASSOCIATION WITH:

tolero LANDSCAPE DESIGN
Mishka Sternbeck
P.O. BOX 203 RUTHERFORD NSW 2320
Mob: 0422406588
email: mishkas@optusnet.com.au
Member ALIDM
Diploma in Landscape Design

SITE ADDRESS

INDUSTRIAL UNITS
LOT 1, DP 1195449
130 COMMORANT ROAD
KOORAGANG

CLIENT
BROWN COMMERCIAL BUILDING

ARCHITECT



DRAWN	DATE
JK	08/01/2024
SCALES	CHECKED
	MS

SHEET	JOB No.
3 OF 3	
Specification Plan	BROW1111223